



SUE Spun Pendant

MANUFACTURING IN THE
UNITED KINGDOM

- Aluminium spun pendant body
- High transmission opal diffuser*
- Tridonic or Philips LED modules and drivers
- Supplied with adjustable 3m drop wire suspension kit
- Inside of shade is satin white as standard
- High colour consistency 3 step MacAdam
- High colour rendering CRI>80
- Various powder coated finishes
- IP20 rated
- 5 year warranty on LED system

PRODUCT CODE		
Product	SUE	Sue Pendant
Lamp Type	E27	E27 Lampholder
	STR	Star LED
Driver	X	No Driver (E27 Lampholder)
	S	Standard Driver
	D	Dali Driver
	W	Wireless Dim
	A	1-10V Driver
Output	T	Touch Dimming Driver
	X	E27 lampholder
	03	3200 Lumens
	05	5500 Lumens
Colour Temperature	07	7200 Lumens
	09	9200 Lumens
Colour Rendering	3	3000 Kelvin
	4	4000 Kelvin
Body Colour	S	Ra80
	N	Ra90
	W	White
Cable Colour	B	Black
	S	Silver
	O	Other/Specified
	W	White PVC
Cable Colour	B	Black PVC
	G	Grey PVC
	T	Transparent

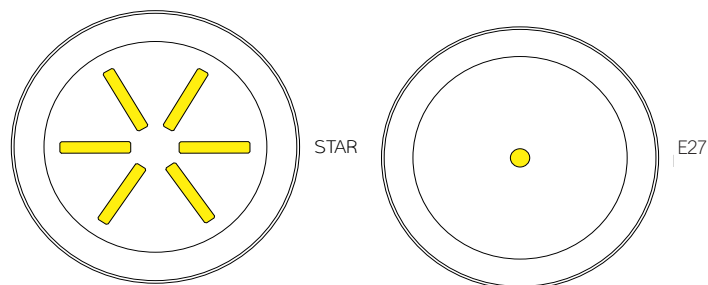
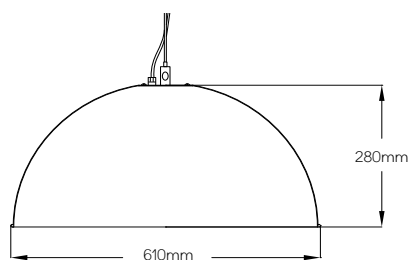

* 500mm Star only (STR)

Ambient operating temperature 25°C

