



SCOUT Linear

MANUFACTURING IN THE
UNITED KINGDOM

- Body constructed from powder coated steel
- High transmission opal diffuser as standard
- Tridonic or Philips LED modules and drivers
- Stand alone or continuous run lighting system
- High colour consistency 3 step MacAdam
- High colour rendering CRI>80
- Bespoke/project specific sizes and outputs made to order
- End caps, joining brackets and variety of optics available to suit all applications
- Various powder coated finishes
- IP20 rated
- Wireless option available
- Optional LiFePO4 Lithium Battery for extended life
- 5 year warranty on LED system

Standard Body

Compact Body

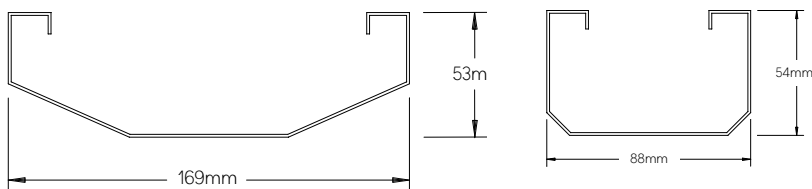

Ambient operating temperature 25°C

PRODUCT CODE	
Product	SC Scout
	SCC Scout Compact
Mounting	SP Suspended Mount
	SF Surface Mount
Body Size	11 Length (1125mm)
	14 Length (1405mm)
	17 Length (1685mm)
	23 Length (2250mm)
Drivers	S Standard Driver
	D Dali Driver
	B DSI Driver
	A 1-10V Driver
	T Touch Dimming Driver
Output	04 4000 Lumens (1125mm)
	05 5000 Lumens (1405mm)
	06 6000 Lumens (1685mm)
	12 12200 Lumens (2250mm)
Colour Temperature	30 3000 Kelvin
	40 4000 Kelvin
Sensor	- No Sensor
	MS Mini Sensor
	PL PIR Low (up to 3.5m)
	PM PIR Mid (up to 12m)
	PH PIR High (up to 16m)
Emergency	- No Emergency
	EL 3 Hour Emergency
	ST Self-Test 3 Hour Emergency
	ED 3 Hour Emergency Dali EM Pro
Body Colour	W White
	B Black
	S Silver
Diffuser	OP Opal
	CL Clear
	NB 60° Narrow Beam
	MB 90° Medium Beam

